



Spooky² Scalar

INSTRUCTION

November 2018
Spooky2 Team

Our Mission:

We will eliminate all illnesses and needless suffering.

Our Vision:

We aim to empower people to take control of their own health and live long, healthy, fulfilling lives with happiness and joy.

Our Value:

We value love, compassion and honesty over profit.

Brief Overview

1

Parcel Contents

2

Detailed Overview

3

Setting up Spooky2 Scalar

4

Tuning

5

How to Apply Scalar Energy

6

Important Notes

9

Specifications

9

Legal Notice & Disclaimer

10

Brief Overview

The key to healing is information - Scalar information. Our cells communicate using Scalar fields. When this communication is blocked, our health suffers. Spooky2 Scalar can restore our body's natural healing mechanisms.

Spooky2 Scalar is the first Scalar treatment device to provide three different methods of sending healing Scalar waves. You can choose which of these best suits your needs. You can read more in the "How to Apply Scalar Energy" section.

Spooky2 Scalar is comprised of two black cases. One is called a Transmitter, and the other, a Receiver. The Transmitter is turned on and tuned. Anyone between the lids of the two cases receives life-giving Scalar waves. Scalar treatments can be that simple.



Parcel Contents



Transmitter Box x 1



Receiver Box x 1



Link Cable x 1



Power Cable x 1



BNC Cable x 1

Detailed Overview

Transmitter Panel:



Receiver Panel:

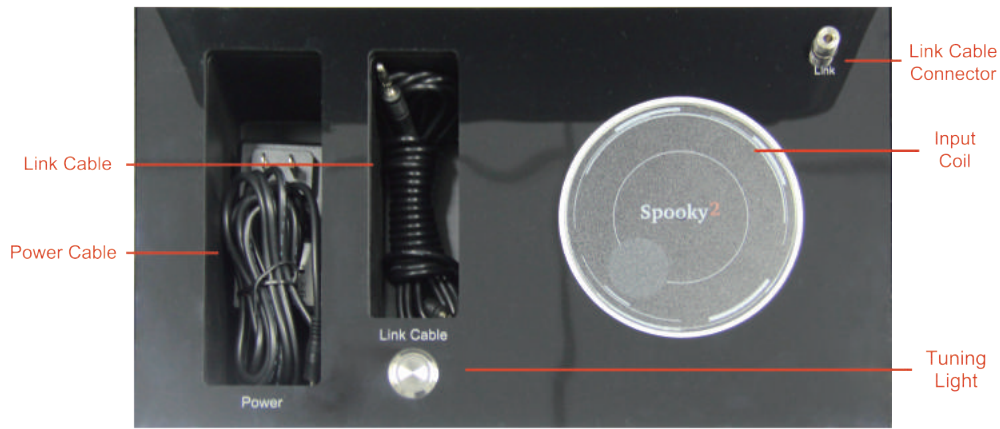

Setting Up Spooky2 Scalar

Starting Scalar treatments is a breeze. There are 4 simple steps:

- 1.** Place the Transmitter and Receiver either side of a chair or bed.
- 2.** Connect the 12V Power Adapter to the Transmitter Power Port.
- 3.** Plug the Link Cable into the Transmitter and Receiver Link Connectors.
- 4.** Turn on and tune the Transmitter.



Tuning

Just like a radio, Spooky2 Scalar requires tuning. It is very simple to do.

Turn the Tuning Adjustment knob anticlockwise until the Tuning Light beside the output coil is at maximum brightness.



Important Note

The tuned frequency is usually between 5 MHz and 7 MHz.

How to Apply Scalar Energy

Spooky2 Scalar can apply Scalar energy in three different ways: Pure Scalar, Molecular Scalar, and Rife Scalar.

Pure Scalar

This is the easiest way of applying healing Scalar energy. Because nothing special needs to be done. Tune Spooky2 Scalar, then sit or lie between the Transmitter and Receiver. Pure Scalar energy then flows between the Transmitter and Receiver.

Molecular Scalar

The Scalar signal can be enhanced by placing a substance on the input coil. The molecules within the sample will change the signal between the lids. And you get the curative effect of the chemical. The substance can be essential oils or drugs. For instance, you can place peppermint oil on the input coil, and you will receive the benefits that peppermint oil provides.



Scientific studies have proven that information alone can cause destruction to pathogens. Poisoned cancer cells on the input coil will induce death of cancer cells inside your body. The information of dying cells is being passed to your internal cancer cells, and they also die.

Rife Scalar

The third way to improve the Scalar waves is Rife Modulation. It combines the discoveries of Royal Rife with Nicola Tesla. Royal Rife found that pathogens respond to a particular frequency. Spooky2 Scalar can apply this frequency using healing Scalar waves. Only Spooky2 Scalar can modulate the original frequencies of Royal Rife. It turns Spooky2 Scalar into the world's most advanced Rife machine.

After Spooky2 Scalar is tuned, connect a Spooky2 generator to the Generator port on the Transmitter box. Sit between the Transmitter and Receiver while programs are running. Spooky2 Scalar accepts any frequency from the massive Spooky2 database.

If you are new to Spooky2 Rife Machine, you can read more information on spooky2.com and spooky2-mall.com.



You can put a glass of water on the output coil during Molecular or Rife Scalar treatments. This is the process called frequency imprinting. After you put the glass on the output coil, retune your Spooky2 Scalar before your Scalar treatment. When you finish the Scalar treatment, you can drink this water during the day to enhance the treatment effects.

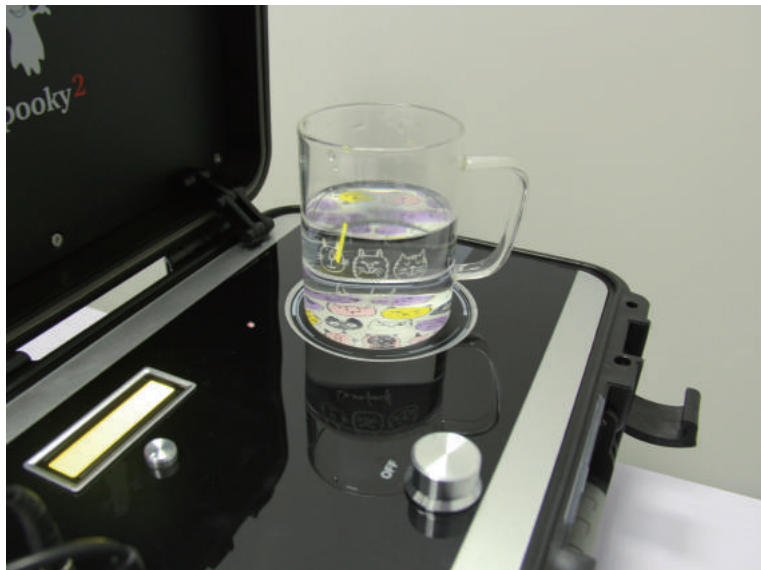

The two modulation methods can be used simultaneously to further improve effectiveness of treatments. For example, to treat Cancer, you can place Frankincense, Peppermint, Lavender, Evening Primrose and Citrus essential oils on the input coil, and run cancer-killing programs on the connected Spooky2 generator.

For example, people with cancer may wish to place a chemotherapy drug on the input coil to induce cancer death in their body. Adding a cancer toxin to a sample of their urine or blood and placing that on the input coil will improve results further, as the information of the cancer cells dying will be transferred to the cancer cells in the body. They too will die.

Important Notes

- 1.** Tune before each treatment. The tuning point may vary each day according to the temperature and humidity, as well as the layout of the machine.
- 2.** Please turn off the Receiver Tuning Light during Scalar treatments.
- 3.** The Transmitter and Receiver should have their lids facing each other.
- 4.** Keep the link cable between the Transmitter and Receiver away from metal.
- 5.** People who are pregnant or have a pacemaker should not use Spooky2 Scalar.
- 6.** Overnight treatments are perfectly safe. You do not get “Frequency Fatigue” from overexposure to Scalar fields. Your body takes what it needs and disregards the rest.
- 7.** It's best not to share the Scalar field with anyone who has serious illness.
- 8. Free Gift: BNC Cable**
We provide a BNC Cable in your parcel. You can use this BNC cable to connect with Spooky2 Generator to experience Rife Scalar Treatments. It's not needed for Pure Scalar or Molecular Scalar treatment.

Specifications

Transmitter Size: 170mm (H) x 360 (W) x 290 (D)
Receiver Size: 170mm (H) x 360 (W) x 290 (D)
Weight: 11 kg
Power Adapter: 12 VDC 2A
Input Current Maximum: 0.6A
Frequency Range: 1.00 MHz – 8.00 MHz
Frequency Step Size: 50 kHz
Scalar Flow: 30mA
Free Gift: BNC Cable

Legal Notice & Disclaimer

Spooky2 Scalar is intended for using as an experimental electronic device only. It is not intended for the diagnosis, prevention, cure, treatment, or mitigation of any disease or illness in human beings.

People and/or entities involved in the development, manufacture and/or marketing of Spooky/Spooky2 equipment (hereafter referred to as “we” or “us”) make no medical claims whatsoever for the Spooky2 Scalar and/or Spooky2 frequency generation system. If you have a problem with your health, please consult a licensed healthcare professional.

Please note that we are not responsible whatsoever for the use, abuse, or misuse, intentionally or unintentionally, of the Spooky2 Scalar and/or Spooky2 frequency generation system or any of its component parts due to any circumstances beyond our reasonable control. In any case, we shall have no other liability.

By using the Spooky2 Scalar and/or Spooky2 frequency generation system, you, the user, understand and accept that you have no expectation of curing any ailment.

You also understand that possible negative physical and/or mental effects, unknown to us, might result from the use of the Spooky2 Scalar and/or Spooky2 frequency generation system. Moreover, you intend to undertake only responsible experimentation, and you voluntarily accept all responsibility for the use and application of Spooky2 Scalar.

Furthermore, you agree that you will not hold us responsible for any consequences, whether harmful or otherwise, that may occur as a result of using the Spooky2 Scalar and /or Spooky2 frequency generation system.

Spooky²