

AVENTOS HK-S

Assembly instructions

Required parts

Lift mechanism set

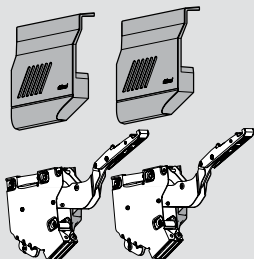

Set includes:

- Lift mechanism (qty 2)
- Cover plate (left and right)

Also includes:

- SCHR 4X35 — #7 x 35 mm (1-3/8") wood screw (qty 10)

Power factor	Opening angle	Part no.
19 — 39	107°	20K2B00.NA
40 — 85	107°	20K2C00.NA
86 — 177	107°	20K2E00.NA

Wood or wide aluminum door mounting plate



- Wood or wide aluminum mounting plate (qty 2)
(for use with AVENTOS HK-S only)

Part no.

Wood or wide aluminum mounting plate	20K4A00
Installation screw for wood doors	606N or 606P
Installation screw for wide alum doors	7072A

Narrow aluminum door mounting plate



- Narrow aluminum mounting plate (qty 2)
(for use with AVENTOS HK-S only)
- Includes 699.1100 installation screws (qty 4)

Part no.

Narrow aluminum mounting plate	20K4A00A
--------------------------------	----------

Recommended parts for tension adjustment

Use of a POZI bit insert and bit holder is recommended when adjusting the tension of the lift mechanism.

Part no.

#2 x 2" POZI bit insert	POZI BIT #2x2
1/4" bit holder	BIT HOLDER

Assembly

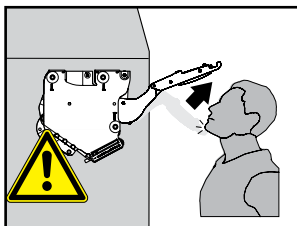

WARNING

Risk of injury from spring-loaded arm

- Do not push arm assembly down or leave in the down position
- Remove mechanism before installing or removing cabinet

1 Locating pin locations and minimum depth

Panel

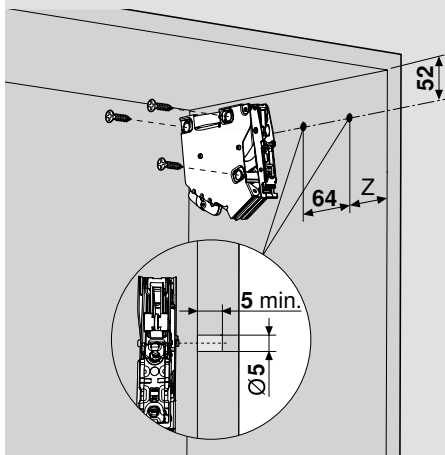

Face frame

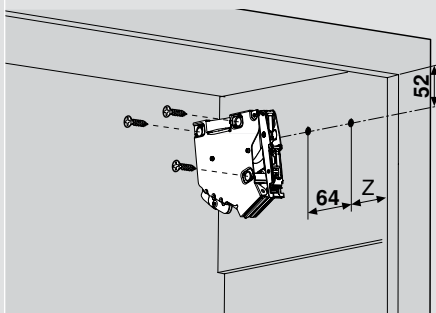

NOTE: Face frame cabinets must be blocked out flush with the frame.

Overlay	up to 20	24	26
Z	37	35.5	34.5

Part no.

Universal individual template is available for pre-boring locating pins

65.1051

2 Attaching the lift mechanism

- Use the template to pre-bore the locating pin holes for the AVENTOS HK-S lift mechanism.
- Align the lift mechanism with the cabinet using the two locator pins, and secure the mechanism with the three mounting screws provided.

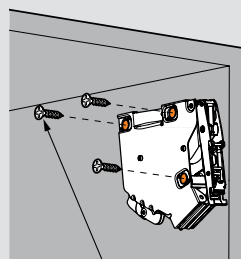
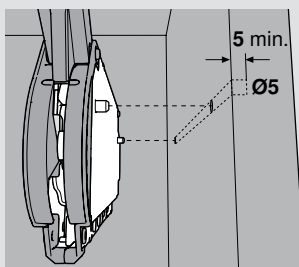

Wood screws **SCHR 4X35**

Attaching the mounting plates

3a Wood/wide aluminum frame doors

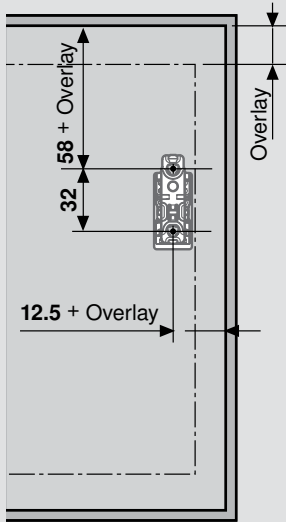

3a Narrow aluminum frame doors

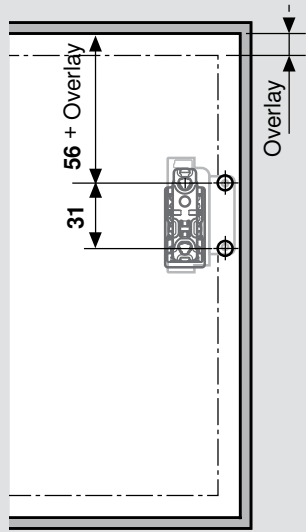

NOTE: Attach each mounting plate with two 606N or 606P wood screws for wood doors, two 7072A screws for wide aluminum doors or two 699.110 screws for narrow aluminum doors

4 Raise lever arm assembly with caution

A

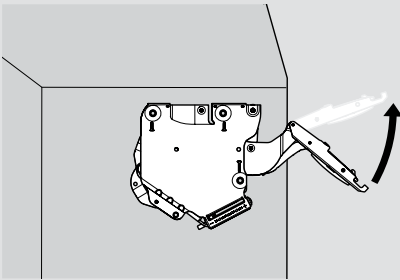

Standing at arm's length carefully raise the arm to the upright position.

B

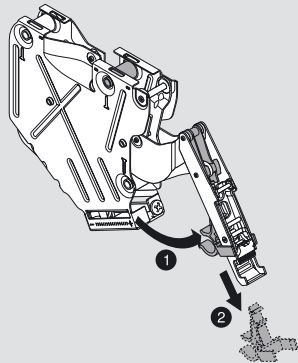

For the 20K2B00.NA, carefully remove the plastic tab .



Risk of injury from spring-loaded arm.

NOTE: Do not remove plastic tab until just before attaching the door

Assembly

5 Attaching the door

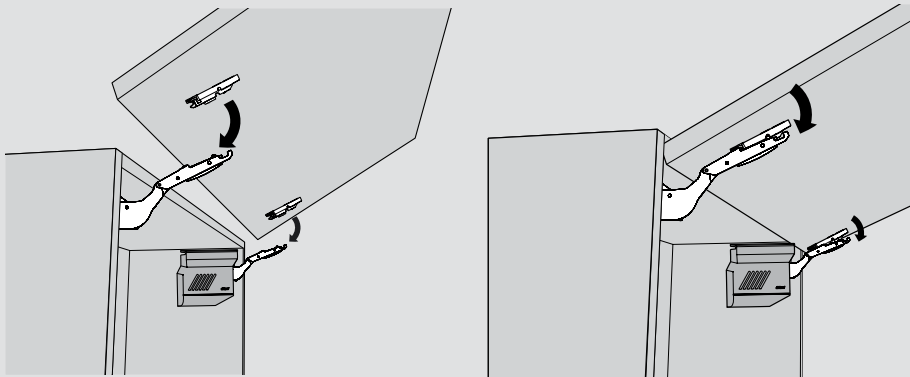

Attach the door using the CLIP mechanism in the mounting plate.

6 Adjust the door tension

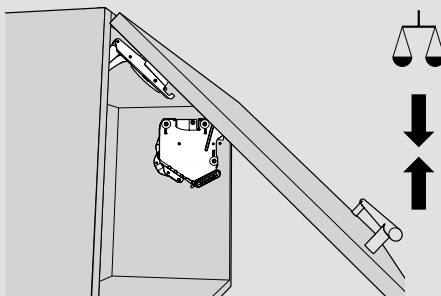
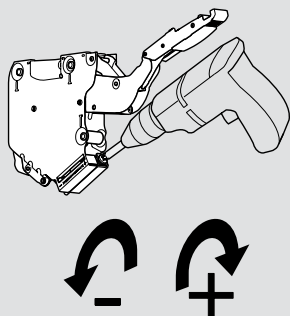

Use a screw gun, POZI driver bit insert and bit holder to adjust each lift mechanism to the desired tension.

7 Finalize the door adjustments

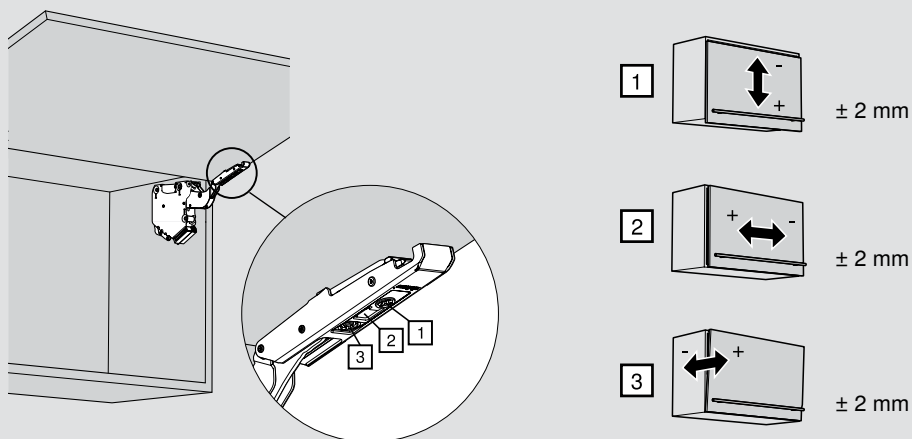

Use a POZI screwdriver on cam adjustments for each of the three 3-dimensional adjustments.

8 Attach cover caps

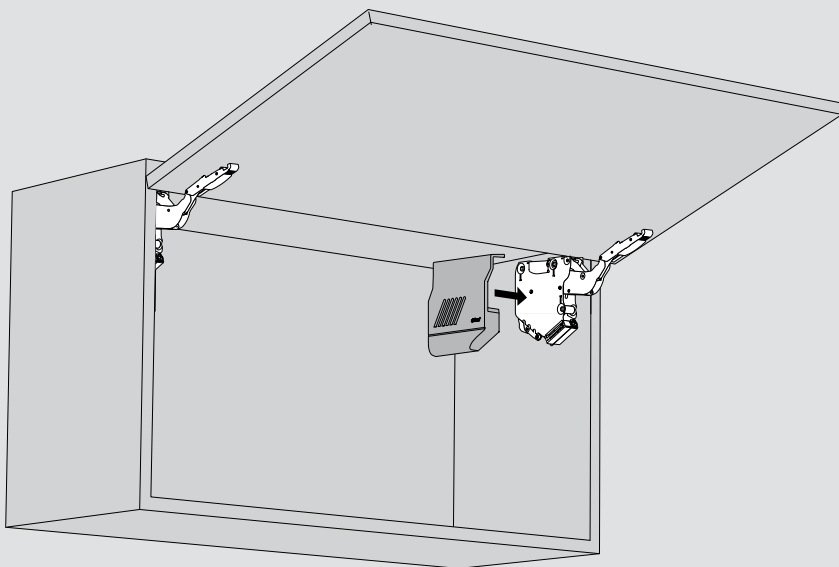

Place the left and right cover plates over the appropriate lift mechanisms and snap them in place.

Removal

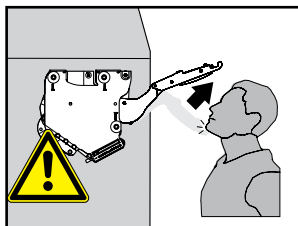

WARNING

Risk of injury from spring-loaded arm

- Do not push arm assembly down or leave in the down position
- Remove mechanism before installing or removing cabinet

1 Removing the door

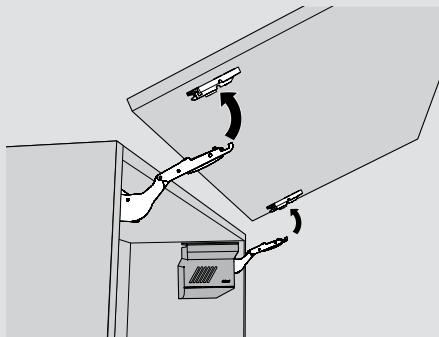
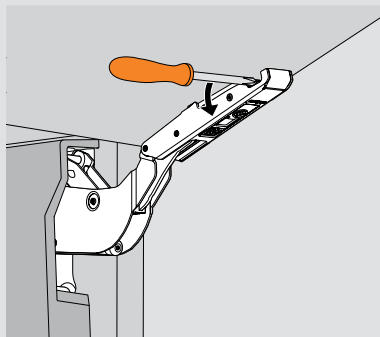

- Disengage the CLIP mechanism of the lever arm from the mounting plate
- Support the door with one hand and repeat on the other side

2 Removing the covers

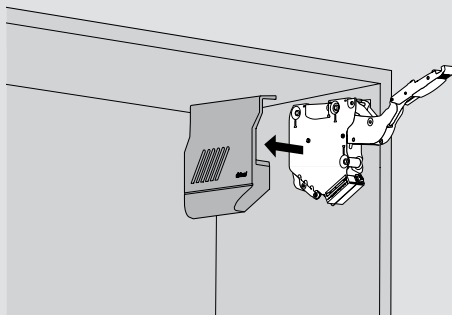

Remove the cover plate.

Other information

Panel door clearance

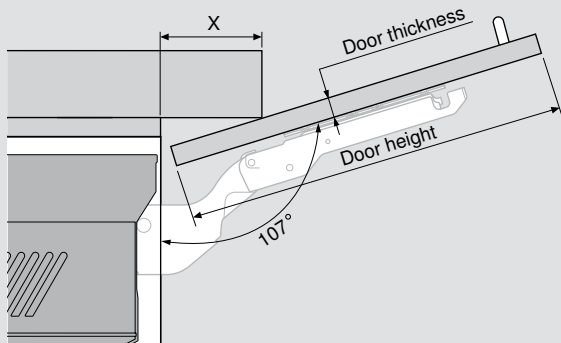

Door thickness	16	19	22	26
X	70	59	49	35

Face frame door clearance

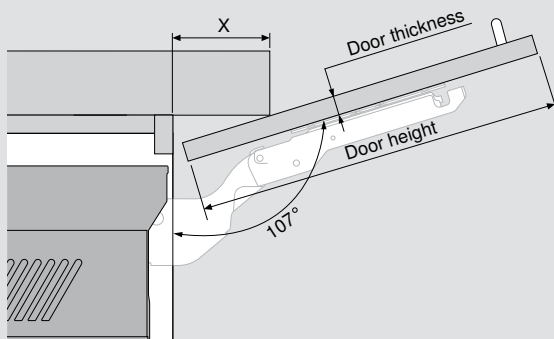

Door thickness	16	19	22	26
X	70	59	49	35

Inch		mm
1/32	.031	1
1/16	.063	1.5
3/32	.094	2
1/8	.125	3
5/32	.156	4
3/16	.188	5
7/32	.219	5.5
1/4	.25	6
9/32	.281	7
5/16	.313	8
11/32	.344	9
3/8	.375	9.5
13/32	.406	10
7/16	.438	11
15/32	.469	12
1/2	.5	13
17/32	.531	13.5
9/16	.563	14
19/32	.594	15
5/8	.625	16
21/32	.656	17
11/16	.688	17.5
23/32	.719	18
3/4	.75	19
25/32	.781	20
13/16	.813	20.5
27/32	.844	21
7/8	.875	22
29/32	.906	23
15/16	.938	24
31/32	.969	24.5
1	1	25.4